



NANA NEWS

MAY 2022

Published by :The North Avondale
Neighborhood Association
PO BOX 16152 Cincinnati OH 45216
Voice mail: (513) 401.5356
Email: nanacincinnati@gmail.com
Website: Northavondalecincinnati.com
Facebook: North Avondale Neighborhood
Association Cincinnati
Volume LXI No. 8
President: Heather Herr
Editor: Charlene Morse

PRESIDENT'S MESSAGE



Dear Friends and Neighbors,

There have been many questions and concerns about the April general meeting. I was not able to present the meeting because I was in Florida for a National level swim meet with my daughter Shay. Unfortunately that meant that Ethan had to run the meeting as vice president and also be in charge of zoom. There were many in person (as well as zoom) attendees and

logistically this meeting also have to navigate guests between 2 separate rooms due to technical issues with the equipment at the North Avondale Rec Center venue. All of this created many challenges and Ethan did his very best to help manage all of this.

The meeting agenda was dividing into two major categories. The New School, which has been on the agenda for many months. Also, the information on the proposed Rosemary's Babies. We have had many questions and some confusion around that portion of the meeting. We received this from Rosemary's board member, Elaine Bobbey, and have been asked to share. Please go to the NANA website and see this article and click on the link.

●Rosemary's Babies Company response to the document, "Call to Action," published on 4.11.2022, and discussed as part of the agenda for the 4.12.2022 NANA General Meeting.

We have worked very hard on trying to communicate this information to everyone but ultimately the city will decide. I would like to thank my husband Jeff and Beth Ewing for their hours of work and meetings with this issue.

I also would like to thank board members: Ethan Perry, Patrice Watson, Morgan Rottinghaus, Ryan Jarrell, Sandesh, Samdaria: Robin Senser and Committee chairs: Jolene Struebbe, Coral Weigel, Judy Evans, and Carolyn Gillman.

Serving on the NANA Board for the last four years has been very challenging but also very rewarding. I am passionate about our community and neighborhood. It was an honor to serve and I look forward to volunteering in other capacities in the future.

Heather Herr

2022-2023 NANA Nominating Committee

Heather Herr (chair & Rose Hill Area), Carolyn Gillman (Rose Hill Area), Linda Mathews (South of Clinton Springs), Charlene Morse (immediate past chair and south of Mitchell to Dickson area), Ethan Perry (Board Rep, South of Mitchell to Vine Area), Maura Wolf (East of Reading area)

You must pay your dues to vote in the election

NANA
ANNUAL MEETING & NEIGHBORHOOD SOCIAL

JOIN US FOR THE ANNUAL MEETING AND COME MEET YOUR NEIGHBORS

Come see the unveiling of our new NANA logo and pick up a magnet to show our pride of our neighborhood!

SUNDAY, MAY 22, 2022
At The Belvedere, 3900 Rose Hill Ave

Annual Meeting at 3 p.m.

Neighborhood Social 4 – 5 p.m.
Adults only for the social RSVP by May 6

You have to register to attend the social. Space is limited. RSVP by clicking below or scan the QR code. Questions, email TCCRob3@gmail.com.

To Register:

https://forms.office.com/Pages/ResponsePage.aspx?id=DQSIkWdsW0yxEjajBLZtrQAAAAAAAAAAAO_QXZ1tdUNkswMVFDN0FDSktOODVLNUxTMlIGREJPWi4u

Proposed Slate for the 2022/2023 NANA Board of Trustees

- President: Sarah Koucky (Rose Hill Avenue)
- 1st Vice President: Patrice Watson (Avon Fields Place)
- 2nd Vice President: Elizabeth Tye (Red Bud Avenue)
- 3rd Vice President: Robin Senser (Burton Woods Lane)
- Recording Secretary: Rocco Rossi (Barry Lane)
- Corresponding Secretary: Troy Robinson (Red Bud Avenue)
- Treasurer: Sandesh Samdaria (Barry Lane)

COMMITTEE UPDATES

BEAUTIFICATION

Did you know that neighbors and friends volunteer and take care of the following gardens and garden plots that beautify our neighborhood?

- Washington Triangle (at Clinton Springs and Washington Avenues)
- Seasongood Park (at the corner of Reading and Clinton Springs)
- Marion Sign and Strip (near Dana and Reading)
- The North Avondale Sign
- The Roundabout Garden
- Kessler Memorial
- Pamela Smitherman Memorial
- The Victory Parkway Garden beds (more information is coming this Summer about the Victory Parkway Garden transition)

These are a lot of spaces that provide a welcome home to each of you daily! You can help keep these gardens in tip top shape by volunteering to weed or plant them, at your convenience, or by donating for their upkeep. While two of the gardens are supported by the Cincinnati Parks, the rest need funds to keep our volunteers from using their own money. Including irrigation, our annual community garden expenses are about \$1500. You can make a donation to NANA and earmark it "Beautification" and reach out to me or Judy Evans to sign up to come dig in the dirt! All are most welcome! You will learn more about our garden volunteers and Beautification donors in upcoming issues of NANA News.

I had the pleasure of attending a lecture by **Molly Hendry, Birmingham Botanical Gardens**, this past winter. You may want to google her or check out her YouTube tutorials. She is most inspiring. And, for those of us without professional landscape design support and trying to design our own flower borders, she suggests the following: **IMAGINE** what you want each season to feel like. **IDENTIFY** your favorite plants you want to incorporate. Make a list and plan for them as seasonal surprises or plant them in a large mass. **LAY OUT** your larger drifts - the bit impact layer, the long season bloomers. **WEAVE** in seasonal thrills. **THREAD** in a touch of whimsy throughout - add in your personality!! Think of daisies dancing the length of the border. And, finally, **OBSERVE** - take notes of what worked and ideas for next year! I am currently suspending the "yard of the month" but will be on the lookout for gardens of note, especially hand done, for future issues of NANA News.

One neighbor shares her experience with Winter Sowing--- **Michelle Ernst (Red Bud Place)** gave Winter Sowing a

try this year. This planting method starts in the winter and involves filling water jugs (or any container) with potting soil, then sowing seeds, sealing the jugs, taking the tops off and leaving outside in the cold



months. The rain and snow usually keep the soil moist enough (if not, water!), and the seeds are put through a natural cold stratification. Then, as the air warms in the spring, the seeds germinate. Seedlings that follow are strong and hardy by having been outdoors. Michelle started most of her 100 jugs (generously donated by Anne Marie Brandt) in January and February, so start collecting jugs now if interested. To learn more, please visit the following links:

- <https://www.facebook.com/groups/wintersown>
- <https://www.youtube.com/watch?v=SKXY6dl-5Tk&authuser=0>
- <https://upstategardenersjournal.com/winter-sowing-a-gardeners-winter-delight/>

Jolene Struebbe, Beautification Chair

Help Wanted. - Spring is here !!



I've agreed to help with the gardens at Marion and Dana circle. However, still looking for volunteers if anyone would be able to help out it would be appreciated. Judy and I met and will continue to recruit anyone who can give an hour or two of their time occasionally.

Megan Rothe (Clinton Springs Ave.)

We would be grateful if you could help us maintain one of these gardens.

Please contact Judy Evans if you are able to volunteer or would like more information about these opportunities for service nanacincinnati@gmail.com. Any gardening help in our other community gardens would be most welcome.

Judy Evans, NANA Community Garden Chair.

NORTH AVONDALE WELCOME WAGON

When you were growing up, did the welcome wagon or newcomer's club ever visit your family when you moved to a new neighborhood? I remember this and loved it, as did my mom. I'd like to create the same welcoming feeling to all new residents of North Avondale.

Would you like to help me? I am really looking for participation from all sections of the neighborhood! Please come forward! The goal would be to personally greet each new family and share details of how to get involved in the community and leave a small gift. This group may be similar to the "sunshine" teams many of you may have at church. This will not be realtor sponsored, but neighbor and neighborhood sponsored!

This will be FUN! Please reach out to me if you'd like to help. The next meeting is **Wednesday, June 8 at 5:30pm.**

Jolene Struebbe, jmstruebbe@gmail.com



LONGEVITY IN NORTH AVONDALE

An ongoing project to record our history from those who have lived in the neighborhood the longest! Please reach out to me, Jolene Struebbe, jmstruebbe@gmail.com if you would like to tell your family story.

Jolene Struebbe

While not necessarily a longevity candidate (as we are learning for North Avondale), I introduce you to **Ken Brawner of 3 Revel Court** to share a snippet of house buying 1990's style.



Ken was living in Madisonville, when his friend and realtor told him, "You are a rising young executive; you need to live in a better neighborhood". While this statement may be a matter of opinion, it did prompt Ken to start looking at various different neighborhoods!

Ken had several options when he came to explore North Avondale in 1992. He knew he wanted a fixer upper with a big yard. Once he walked into the foyer of 3 Revel Court, he knew he had found his home. Ken's back yard is 13 acres of woods- all unbuildable, and with property taxes on that land being paid by the owner and adjoining neighbor on Washington Ave. Taking all of this into consideration, he told his realtor he would take it before he even looked at the upstairs. He just got a good feeling about the place!

The home was listed for \$139,000. Ken had done his homework and discovered that in 1992 most homes in North Avondale were on the market for more than one year before they sold. He got wind that the sellers of 3 Revel Court were in a hurry to get to their new location so he took a gamble and offered \$90,000, as is, with no inspection. Surprising even his realtor, his offer was accepted! The home was in bad shape; for example, not one of the four bathrooms was functioning properly. Fortunately, he had been preapproved for a "purchase and remodel" loan; he had \$100,000 to spend on home improvements but it had to be done in 90 days. Ken says it was not a problem to do this- and he could have spent more! (Well at least that part of homebuying in North Avondale may still be true for some of us!)

Ken loves the mix of ethnicities and religions on his small street. Ken has been active in NANA and NABA and I also learned he was someone who planted the Washington Triangle Garden years ago. This Beautification Chair thanks him and is glad that we have had volunteers come together in 2021 to get the garden in shape again!

Danny Adler, born in 1949, moved to **4009 Redbud Avenue** in 1950 (from College Hill) with a brother and sister and his parents. While Danny was gone from North Avondale by 1971 (and his parents by 1975), I share his story and that of his family as a snapshot of what living in and growing up in North Avondale was like during the 1950's and 60's, even as you will find that Danny was never your "typical" Jewish kid.



Mom and Dad: Danny's mom, Emily Adler, grew up on Forest Avenue and his dad, Tom Adler, grew up on Beechwood Avenue. Emily's family owned the Frank's tea and spice company and were responsible for introducing mustard into the USA! Tom's family owned the Adler Sock and Hosiery Company and ultimately patented socks with "SC" (Shrink control). After WWII with their factories aging, many small, family-owned, Jewish businesses were being taken over by larger stores, such as Sears, yet Tom did not bow to Sears. He hired a chemist to research a solution to wool socks that shrunk in the wash, got those processes patented, and negotiated with Sears to keep his name on his socks. Tom ultimately ended up as the Chairman of the Board for Burlington Coat Factory. Many families living in North Avondale at this time were Jewish merchants.

Danny mostly hung out with other Jewish kids from more conservative Eastern European families in the neighborhood. They played "cowboys and Indians" and all had major obsessions with Davy Crockett and his fuzzy hat. He still remembers the day in the Fall of 1956 when a new 1957 white on white Mercury convertible drove down the street into a neighbor's garage. He said it was like a "spaceship sedately came down Burton Woods Lane", with such huge tail fins, stopping long enough to show the boys how with a push of a button the top came up. Fathers were mostly business men, executive types, coming home at night with their suits on for cocktail hour – much like the TV show "Leave it to Beaver".

Danny describes his siblings as "the good ones" and nearly a decade older than he was. Like many kids in the neighborhood, Danny went to North Avondale School. Yet, on the first day of kindergarten he says he was branded a "troublemaker" – a name that stayed with him until he left for Cincinnati Country Day in 5th grade. He describes the school in that era as built of "grey cement walls with air raid sirens on the roof and lots of air raid drills". Things didn't start out any better at CCD, when, on the first day, he made a major 5th grade faux pas. At the end of the school day, it was customary for the children to line up alphabetically and bid the teacher good night. The girls were first and did so with a courtesy to the teacher. Danny, was at the beginning of the

(Continued on page 4)

(Continued from page 3))

line for the boys (Adler), followed suit and said good night and without knowing any better (it was his first day he says!) also did a courtesy. You can only imagine the reaction! Danny says it was a long bus ride to CCD with pipe smoking Walter as his bus driver. Even though his family were non observant Jews, he was hazed. He said he experienced mild antisemitism and became aware that he was different from other kids at CCD. And, he says, "it didn't help that he was non-conformist, unpredictable and had a short attention span". It was a culture change.

Around 1962-63, Danny befriended David Golden, another neighborhood (Bond Hill) "exile" to CCD and they had a band called the "Bonneville's". Danny played the piano and realized that it got drowned out by the other instruments, so when David showed him how to play a few cords on the electric guitar he was hooked. He got his first guitar that Christmas for \$50 from a pawn shop. It became "life changing" when he learned about Chuck Berry and the Beatles. Danny had discovered Rock n Roll! As a result, he got sent to a Boarding School in MA, with other "round pegs in square holes" for high school, graduating in 1968.

Danny was back in Cincinnati for the summers, however, and he was playing music in jazz clubs and working at the factory. Many of the guys he played with at the clubs were black and he recalls playing 6 nights a week. One night in Sept. '68 he was hanging out with 2-3 black guys and they all decided to go to The Clock Bar on Burnet Ave in Avondale against the better advice of other friends. The guys said "we'll take care of you" and "everything's cool". However, when they walked into the bar, the "whole place went quiet" and the music stopped. He realized that "he was not going to be well received". Some of the patrons followed him and his friends out and began beating them up and stole his watch. His friends tried to take care of him, as they said they would. Yet, Danny says, this experience never soured his outlook on black culture.

Danny went on from here to become a very successful musician and a RR Locomotive Engineer and while THAT story is outside the scope of THIS story, you may want to google him! Danny has a condo at The Regency for when he is back in Cincinnati. Having both visited and recorded at King Studios some time ago, he is part of a group trying to rescue the studio today.

WELCOME NEW NEIGHBORS

- Jason Barnes & Emily Boehmler at 1026 Avondale Avenue
- Burton M & R LLC at 979 Burton Avenue
- 739 Chalfonte LLC at 739 Chalfonte Place
- Joseph & Elizabeth Stewart-Pirone at 739 Avon Fields Lane
- Craftsman Properties LLC at 3973 Lowery Avenue
- Prestige Homes INC. at 3872 Vine Street

FUN WITH YOUR NEIGHBORS

☞ We want to keep rediscovering what's fun and makes us happy. We accomplish these things by spending time with family, self-expression and singing at **Karaoke Cocktails & Cappuccinos.**

Popup Shopping & Vendor Eats with a full-service bar.

Music By Dj Tock Boogie

Sponsored by The Clubhouse Cincinnati and Billfold Films

Held once a month from 6-9pm at Drip Coffee Lounge 2927 Colerain Ave. Cincinnati, OH 45225.

For vendor spots please email Karaokecocktailsandcappuccinos@gmail.com

Amp Teez (S. Fred Shuttlesworth)

☞ Jazz singer, **Petra van Nuis**, North Avondale native, now living in Chicago, will be returning to Cincinnati to perform in May as follows:

- Friday, May 20 Petra van Nuis/Andy Brown Quartet w/ saxophonist Dan Drees & bassist Chris Berg 7-10:15 pm

Caffe Vivace www.caffevivace.com

975 E McMillan St. Cincinnati, OH 513.601.9897

RESERVATIONS RECOMMENDED- 2 SETS -- SOLD SEPARATELY

- Monday, May 23

Petra van Nuis/Andy Brown Quartet w/ bassist Chris Berg & drummer Jim Leslie

6-9 pm

Washington Park Porch www.washingtonpark.org

1230 Elm St. Cincinnati, OH 513.621.4400

FREE-OUTDOOR (covered) VENUE

Rosalie van Nuis (Burton Woods Lane)

☞ **Vanessa Sorensen (Marion Ave.)** will be participating in the Paper Ink Press art exhibition by Tiger Lily Press members. The show will be **May 25-June 26 at the Annex Art Gallery in the Pendleton Art Center** (1310 Pendleton St.). The exhibition will include original, handmade etchings, screen prints, woodblocks, linocuts, collagraphs, lithographs, monotypes, monoprints, and letterpress. The **artists' reception is Friday, June 4** from 4-6pm. Gallery hours are Wed-Sat., 12-5pm and Final Fridays (May 27 and June 24, 5-9pm).

View her newsletter <https://mailchi.mp/4881f91c448d/ma-magnolia-woodcut?e=5ce5c81571> and see her newest print

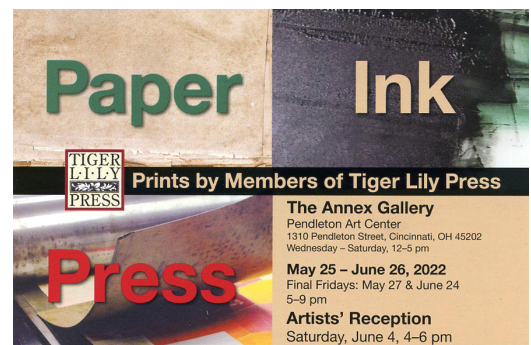

FROM THE CITY

New Crosswalk on Mitchell at Roger Bacon Stadium

Roger Bacon has a large parking lot of 200 spaces off E Mitchell Av. They currently do not allow students to park there in fear of them crossing E Mitchell Av without a crosswalk. There is a crosswalk at the intersection of E Mitchell Av and Vine St, but the students will not walk to the corner to use it.



What prompted this:

- District Five NLU, and St Bernard Police have been receiving complaints of Roger Bacon students parking illegally along the streets on the District Five side of Vine St and the surrounding side streets.
- A meeting was set up with the school principal and DOTE engineer Curtis Hines. There is a City of Cincinnati approved crosswalk and traffic calming plan that can be used. This will bring a section of E Mitchell Av down to two lanes of travel for a half block causing cars to slow down and then there will be a crosswalk installed at approximately 40 E Mitchell Av.
- The projected cost is approximately \$75,000. Per DOTE there currently is no funding for this project.
- It will be beneficial for St Bernard, Roger Bacon, and North Avondale Community.

I am hoping this project can be looked at and find funding. St Bernard may have resources that can be allocated as well as it enters their side of E Mitchell Av.

I am working with City Hall to try an allocate some funding for this project.

I would like to advise North Avondale of the proposal at the **June 14 meeting to get a feel for your input.**

Below are the plans provided by DOTE.

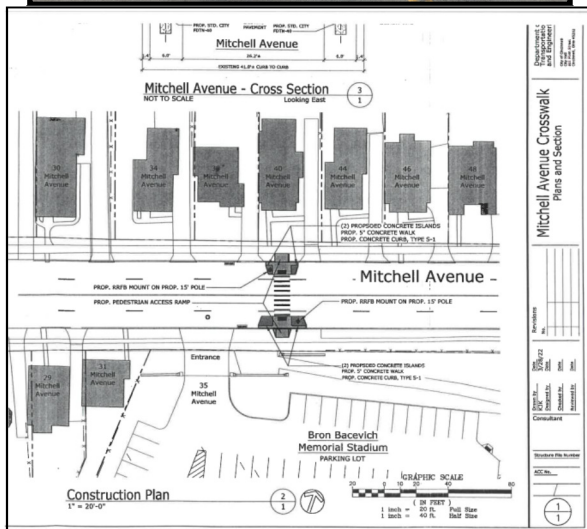

Sgt. Jeffrey J Meister S723, CPD District Four Neighborhood Liaison Unit

The City of Cincinnati is commissioning a public outdoor memorial project to honor civil rights icon Rev. Dr. Martin Luther King, Jr. This memorial will be located at the northeast corner of Martin Luther King Jr. Drive East and Reading Road in Uptown's Avondale neighborhood. It is slated for completion and a public dedication in August 2023 to coincide with the 60th anniversary of Dr. King's "I Have a Dream" speech.

In September 2021, the City announced an open call for artists as the first step of the process. Responses were received and an evaluation committee has narrowed the list to a select number of artists or teams who will be developing design proposals with public input.

The City of Cincinnati is inviting you to share your thoughts and impressions with the artists by completing this short survey. The selection process requires designers to demonstrate they have incorporated community input into their design proposal.

Please complete the survey (<https://www.surveymonkey.com/r/MLKMemorial>)

and share your reflections on the life and legacy of Dr. Martin Luther King. You may even see your vision come to life in Cincinnati's tribute to Dr. King.

City of Cincinnati Department of City Planning & Engagement

City Hall Corner – North Avondale, Mark Jeffreys

100+ days into a new City Council, as a City Councilman, I wanted to take an opportunity to share some of my focus areas that impact the North Avondale community. Right out of the gate, I have focused on issues that I heard repeatedly on the campaign trail: making our streets safer, cleaner, and more inviting.

We are reminded daily of the need to make sure our streets are safe for everyone as crashes continue to mount. In March, I held a **Safer Streets Now forum** in Avondale, which brought in local and national experts to address this issue. We identified several concrete solutions including curb extensions that are better and 10x cheaper than current solutions. The administration is now

(Continued on page 7)

PARKS, LIBRARIES & RECREATION

North Avondale Recreation Center -



- Hours: open Monday thru Friday 10 am to 8 pm; Saturday 9am to 2pm
- Weight Room is by reservations
- Masks must be worn
- Swimsuit drive collecting new and gently used swimsuits of all sizes.
 - Starts **April 1** and runs through **May 27**
- Senior Knitting & Social Group: Monday, 12:00 to 1:30 membership required
- Soccer Unites partnership with FCC: 6 week program; games Tuesday & Thursday Afternoons at the new mini pitch; teaches basic soccer skills and character building; Spring Sessions starts in MID April.
- My name is Lani Lomax and I'm the new Pickleball Specialist for the CRC.
 - Evening Open play Pickleball will start April 7th and will be held on Thursday nights from 6-8pm
 - Beginner Open Pickleball and Lessons on Wednesday mornings from 10am-noon. In the gym. Membership required Supplies provided
- Summer S.T.E.A.M. Specialty Camp.
 - 9am-4pm, Monday through Friday (\$150.00/week)
 - Camp CRC operates: June 6, 2022 - August 12, 2022 (no camp on July 4th)
 - Campers must be enrolled weekly.
 - To enroll, a minimum of \$100/child is due at registration.

STEAM SPECIALTY CAMP
North Avondale Recreation Center
617 Clinton Springs 45229

Dates: June 6-August 12 Ages 5-12
Time: 9am-4pm Cost: \$150/week
Themes: Lego/Robotics, Coding, Gardening, Chess & more!
Other activities include swimming, golf and field trips

Scan below to register!

CAMPS FOR CHAMPS

Pricing
K-2 grade = \$30/week
3-6 grade = \$40/week

Week 1: Soccer
Week 2: Soccer
Week 3: Basketball & Softball
Week 4: Basketball
Week 5: Flag Football
Week 6: Flag Football (no grade 3 & 4 only)

Each camp will be held Monday, Thursday

Camps begin the week of June 6th!

For more information or to register, please scan the QR code provided!

- Tai Chi class during the day beginning April 5th. It will be held on Tuesdays and Wednesdays from 10 to 11 a.m. Larry Hill will be the instructor. Membership required fee Membership required plus fee \$50 per month, \$7 per class

New Tai Chi Class

Location: North Avondale Recreation Center
617 Clinton Springs Ave. Cincinnati, OH 45229
Begin: April 5, 2022
Repeat: Every 14 Days: Tues, Thursdays and Wednesdays
Description: Tai Chi is a low-impact, gentle movement, improves balance, strength and flexibility. Promotes peace of mind.
Cost: \$50 per month or \$7 per class.
Recreation Center Membership Required
Instructor: Larry D. Hill
Sign up by contacting the center at 513-393-1346

Nialani Robinson, Community Center Director

Hirsch Recreation Center - 3620 Reading Road • 751.3393

- Hours: 10am to 8pm Monday thru Friday

- Saturday 9 am - 2 pm

- Hirsch will be receiving meals every Wednesday @ 3:30 from La Soup. If you are in need or know of anyone in need please stop by after 3:30 on Wednesdays to pick up meals.
- The Fade Room (Membership required) Tuesday 5:30 - 7:30pm
 - This program will provide youth 8-13 an opportunity to come into the center for a "barbershop style" experience (video games, sports on TV air hockey etc..) 4 - 30min time slots available per week. Haircuts are free of charge (no styling). Signed permission slip to reserve a time slot
- Kids Chess Club Mondays, 4:30 to 5:30 pm ages 10-15yrs. Contact Sandra Jones Mitchel for more info @ 513-861-2790
- Summer Camp Registration is open.
 - please go to cincyrec.org for more details.
 - Camp CRC operates 10 weeks: June 6, 2022 - August 12, 2022 (no camp on July 4th)
 - 06/06 22 to 08/12/22, 7:00 am - 6:00 pm
 - Part-time enrollment is not available at this time.
- Spinning classes: Mon. & Wed., 6:15 – 7:00 pm. Thursday spin class 10:00 am to 10:45 am It is necessary to sign up before class. To register call 513.751.3393 or go to the front desk.

AVONDALE COMMUNITY GARDENS

AS WE GROW!

HELP US CREATE DIFFERENT GARDENS THAT OFFER FOOD, BEAUTY, AND PRIDE TO OUR COMMUNITY!

Starting Wednesday, April 6th!

EVERY WEDNESDAY 2:30 - 4:30 PM TOOLS AND FOOD PROVIDED!

ALL AGES ARE WELCOME TO JOIN US!
HIRSCH RECREATION CENTER
3630 READING RD, CINCINNATI, OH 45229

Questions? Contact Us!
Jasmine (513) 268-7012
Ms. Brittany (513) 751-3393

- Yoga: Tuesday 6:00pm - call to reserve space.
 - Senior Program: arts & crafts, journaling, walking club, essential oils
- Pick up a Program Schedule at the Center

Brittany Barrett, Community Center Director



NORTH AVONDALE SCHOOLS

NORTH AVONDALE MONTESSORI

513.363.3900 • 615 Clinton Springs www.namrockets.org

NAM Garden & Trails Cleanup THIS Saturday!

Register to volunteer today at: <https://signup.com/go/PMBhoap>



Our 4th Annual Charity Golf Outing at Avon Fields Golf Course on Saturday, May 14, 2022 Funds generated from this event will be used to support the many excellent programs and events that both the Foundation and Fathers



Group sponsor throughout the year. Cost for this outing is \$75 per person/\$300 foursome. This includes: 18 Holes of golf with cart, door prize, and a buffet lunch and drink tickets following the event. Prizes will be awarded following the event.

Golfers will play a “Scramble” and can sign up individually or to a specific foursome.

Golfer Registration: <https://namrockets.org/golf>

Sponsorship Registration: <https://www.namrockets.org/sponsor>

Congratulations to **Ms. Shockley-Matthews** who is a finalist for the Dr. Lawrence C. Hawkins Educator of the Year Award. Thank you for being a dedicated and amazing 6-9 teacher!

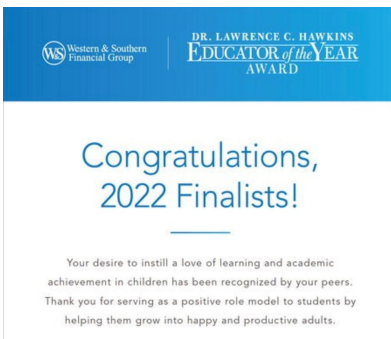

Staci Shockley-Matthews
North Avondale
Montessori School



THE NEW SCHOOL MONTESSORI (TNSM)

513.281.7999 • 3 Burton Woods Lane
www.newschoollmontessori.com

New School Montessori 1st-3rd graders learned about the many forms of writing and the different writing instruments used throughout history. As a souvenir for Montessori's 4th Great Lesson, children constructed their own version of a quill pen(cil). Needless to say, they were all grateful for the modern writing tools we have today!

The 4th Great Lesson begins in ancient Egypt with the early writings of the Phoenicians and how their written language helped influence the Romans and the alphabet they created that we use today. People used to write on clay or wax, but with the use of parchment, the hollow shaft of specially prepared bird feathers from geese, swans or turkeys use capillary action to fill the tube with ink for writing. The Magna Carta and the American Declaration of Independence were both written using quill pens. With the invention of metal pens, quills fell out of favor.



Ann Baumgardner, Communications Director

(Continued from page 5)

exploring how to roll these solutions out. As a down payment on solutions, in partnership with the Mayor, I proposed and City Council passed allocating \$1,000,000 to pedestrian safety initiatives across the city including for curb extensions and speed cushions, both of which are proven to slow down traffic.

Our police also play a vital role in safety, which is why I asked the administration to report on the **number of traffic citations** over the past five years including by neighborhood, and asked the Administration to report on how we can partner with State Highway Patrol to free-up CPD's resources to address our most pressing public safety needs.

To combat littering—a stain on our beautiful city— I am also working with the administration and my colleagues to address the issue of illegal dumping and littering. I enjoy being a part of litter clean ups in neighborhoods, but we need more systemic solutions.

While its early days on City Council, I believe we're making progress in building a Cincinnati of opportunity where our residents can live in safe, vibrant neighborhoods. I would invite anyone to reach out to me any time with issues or concerns Mark.Jeffreys@cincinnati-oh.gov. I appreciate the opportunity to hear from residents, and to serve the people of Cincinnati..

FROM YOUR NEIGHBORS

Metropolitan sewer district did a survey of Wess Park Drive and possibly other areas and has apparently put in a FEMA Grant request to improve drainage in that area. If a grant is approved oh, they would likely have to buy several houses from people and tear them down to put instead a drainage solution. We are absolutely not in favor of this, which was certainly affect Roger Bacon football stadium as well since it is the lowest spot. I just don't think Roger Bacon would be willing to sell their Stadium to improve drainage for Cincinnati.

Any information that NANA can find out about this and post it or let us know about would be greatly appreciated. The only way we found out about it was I simply walked down and ask the gentleman what they were doing.

Richard McKenzie (Wess Park)

I'm a coach and volunteer with the NAM School community. We have 142 players who use the CRC Soccer Fields next to NAM for practices, the school with its 602+ students also uses the fields for gym and recess as do the children who are enrolled in the CRC after school program.

I can't tell you how many times we have had to **pick up large piles of dog poop** that were in the middle of the soccer fields this spring, it's never been this bad in the past, and recently according to maintenance people at CRC it was discovered that our nets which our organization/parents paid for and cost over \$100, were cut down by a neighbor who apparently got tired of having their dog getting caught up in the nets.

It's just deeply disappointing that a neighbor would not consider how their actions would impact others. If your a dog lover, and want to exercise your dogs on what are obviously sports fields, that's fine. But please be considerate and pick up after your dog and do not disturb the field equipment!

Amy Yosmali (E Mitchell)

FUN IN THE CITY

The Over-the-Rhine Museum Remember Field Trips?

Getting out of class, going somewhere different, having fun with your classmates?

What if you could do that now? The Over-the-Rhine Museum is offering you the chance to get out of your routine, go somewhere interesting, and have fun with your grownup friends, family, or workmates! This summer we are offering five different walking tours in the historic Over-the-Rhine neighborhood to showcase the amazing stories found here. Tours are scheduled on Saturdays and Sundays each week from May through October. They conveniently start at 10am and 2pm so you can easily schedule a lunch break before or after your tour at one of our wonderful local restaurants. Or go really old school and pack a brown bag lunch to eat under a shady tree in Washington Park!

Individual tickets are \$15 per person and can be purchased now on our website at www.otrmuseum.org. More dates will be added to the schedule as the season progresses, so check back regularly. Take one tour or several!

For groups of 10 or more we offer a discounted rate of \$10 per person. Contact Donna at hello@otrmuseum.org to arrange your tour. Group tours can be scheduled on the weekend or during the week with advance notice.

The mission of the Over-the-Rhine Museum is to build respect and understanding for those who have lived and worked in historic Over-the-Rhine by preserving and celebrating all the stories that Over-the-Rhine has to tell.

Plan your field trip today!

Contact the museum at hello@otrmuseum.org or 513. 813.7309 for more information

ABOUT YOUR NEIGHBORS

Swim season is long...it is a marathon not a sprint! I am so proud of Shay (on the left) for CLOSING 4 days of swimming (and basically a year) STRONG today. She had a great time competing at the ISCA elite Nationals in St Petes. Due to a week off for a school trip Shay as tapered as she would normally be but we came in to this meet with the attitude to FINISH strong and ENJOY every single moment. Shays medley relays medaled 2nd and 3rd! She finished 18th in her 100 back, 20 in 50 back and 27 in 200 back (there were over 1500 swimmers at the meet). She also achieved her sectional 100 back cut from the relay at about 1:00 flat! @shayherrrrr



Heather Herr (Betula)

Urban Stream Adventure with MCYC May 21, 2022
2022 May Urban Stream Adventure with the Mill

Creek Yacht Club Tick-

ets, Sat, May 21, 2022 at

9:00 AM | Eventbrite

<https://>

www.eventbrite.com/

[e/2022-may-urban-stream-](https://www.eventbrite.com/e/2022-may-urban-stream-adventure-with-the-mill-creek-yacht-club-tickets-321340186147)

[adventure-with-the-mill-](https://www.eventbrite.com/e/2022-may-urban-stream-adventure-with-the-mill-creek-yacht-club-tickets-321340186147)

[creek-yacht-club-tickets-](https://www.eventbrite.com/e/2022-may-urban-stream-adventure-with-the-mill-creek-yacht-club-tickets-321340186147)

[321340186147](https://www.eventbrite.com/e/2022-may-urban-stream-adventure-with-the-mill-creek-yacht-club-tickets-321340186147)

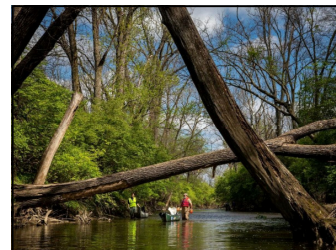

Newsletter: [April Showers Will](https://mailchi.mp/themillcreekalliance.org/april-newsletter-2022?e=94296658e1)

[Bring May Flies? \(mailchi.mp\)](https://mailchi.mp/themillcreekalliance.org/april-newsletter-2022?e=94296658e1)

[https://mailchi.mp/](https://mailchi.mp/themillcreekalliance.org/april-newsletter-2022?e=94296658e1)

[themillcreekalliance.org/april-](https://mailchi.mp/themillcreekalliance.org/april-newsletter-2022?e=94296658e1)

[newsletter-2022?e=94296658e1](https://mailchi.mp/themillcreekalliance.org/april-newsletter-2022?e=94296658e1)

